

- PRE-VEGETATED MODULAR TRAY WITH GROWING MEDIA
- SYSTEMFILTER FABRIC -INSTALL UP FACE OF EDGING AND BELOW MODULAR TRAY
- DRAINAGE COMPOSITE 3811R
- ROOTSTOP HD
- SARNAFIL MEMBRANE
- ROOF BOARD (OPTIONAL)
- INSULATION (OPTIONAL)
- VAPOR RETARDER (OPTIONAL)
- APPROVED SUBSTRATE

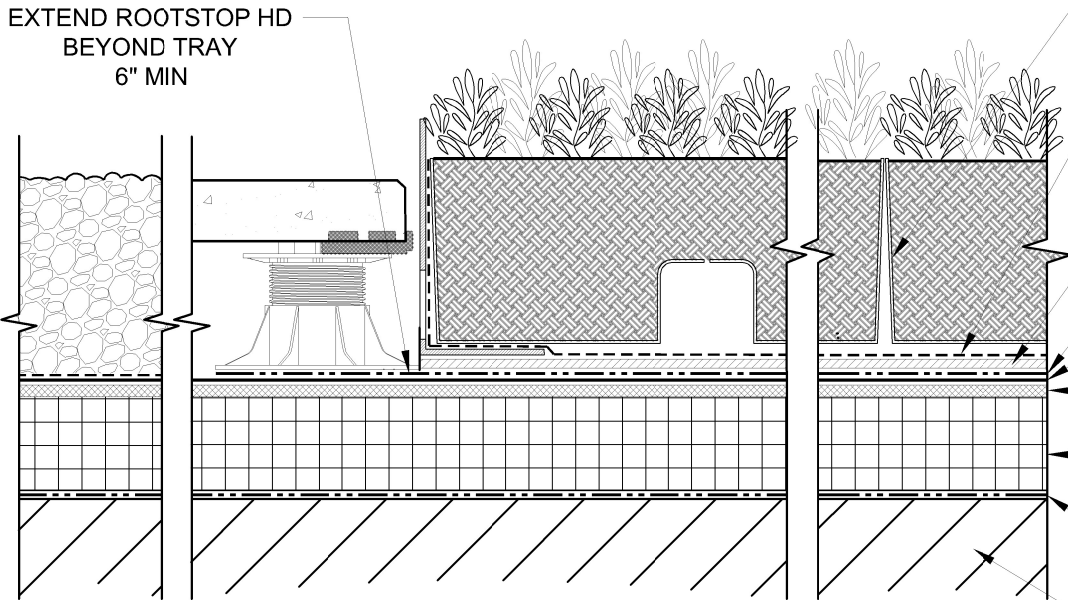

#### NOTES:

1. DRAINAGE COMPOSITE 3811R IS REQUIRED UNDER GARDEN ROOF TRAYS.

## HYDROTECH® GARDEN ROOF TRAY WITH SIKA PVC

**BUILDING TRUST**

312-337-4998

hydrotechusa.com



SCALE:

N.T.S.

DATE:

07/25

FILE NO.:

DRW. NO.:

G-10B

AS A MEMBRANE MANUFACTURER, SIKKA CORPORATION ("SIKKA") REVIEWS DETAILS PREPARED BY THE CONSULTANT, ARCHITECT AND/OR ENGINEER FOR THE PURPOSE OF DETERMINING IF A SIKKA WARRANTY MAY ISSUE FOR THE PROJECT. THIS REVIEW IS NOT TO BE CONSTRUED AS APPROVAL OF DETAILS BY SIKKA AND IS NOT BEING CONDUCTED IN LIEU OF SOUND ENGINEERING AND ARCHITECTURAL PRACTICES AND JUDGMENT AND SHOULD NOT BE RELIED UPON FOR THAT PURPOSE. SIKKA CORPORATION ASSUMES NO LIABILITY WITH RESPECT TO THE DESIGN OF THE ROOFING OR WATERPROOFING SYSTEM, THE ARCHITECT, CONSULTANT AND/OR ENGINEER OR DESIGN PROFESSIONAL FOR A PARTICULAR PROJECT OR SOLE RESPONSIBILITY FOR THE DESIGN OF THE ROOFING OR WATERPROOFING SYSTEM, FOR THE PREPARATION AND APPROVAL OF THE DETAILS AND SHOP DRAWINGS, AND FOR DETERMINING THEIR SUITABILITY FOR A PARTICULAR PROJECT OR APPLICATION, WHILE SIKKA PROVIDES GENERAL INSTRUCTIONS FOR THE INSTALLATION OF ITS MEMBRANE AS WELL AS TRAINING FOR SIKKA AUTHORIZED APPLICATORS, THE MEANS AND METHODS USED BY THE CONTRACTOR FOR SURFACE PREPARATION AS WELL AS THE MEANS AND METHODS EMPLOYED BY THE CONTRACTOR IN THE INSTALLATION OF THE SIKKA MEMBRANE ARE THE RESPONSIBILITY OF THE CONTRACTOR. ALL SALE OF SIKKA PRODUCTS AND SERVICES ARE SUBJECT TO SIKKA'S TERMS AND CONDITIONS OF SALE AVAILABLE AT HYDROTECHUSA.COM.